

525 ROBERTS ST.  
RENO, NV 89502

KRI Architecture & Design  
David Michael Madsen, Architect

No.	Description	Date

A9.11

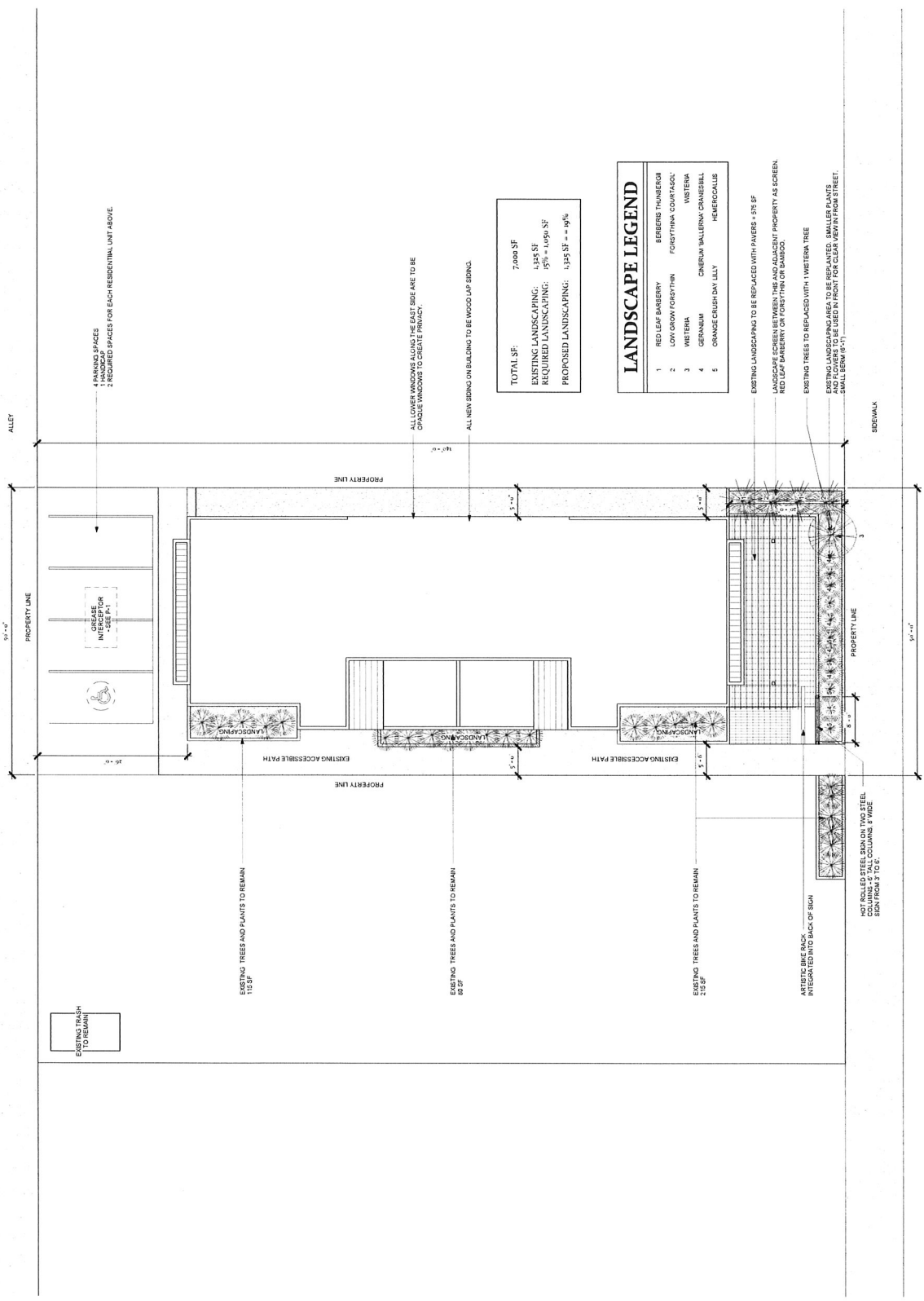

TOTAL SF: 7,000 SF  
 EXISTING LANDSCAPING: 1,335 SF  
 REQUIRED LANDSCAPING: 15% = 1,050 SF  
 PROPOSED LANDSCAPING: 1,335 SF = 19%

**LANDSCAPE LEGEND**

1	RED LEAF BARBERY	BIRBERS THUNDERBOL
2	LOW GROW FORSYTHIA	FORCETHYMA COURT PAUL
3	WISTERIA	WISTERIA
4	GERANIUM	CINERARIA BALLENA CRANESEBELL
5	ORANGE CRUSH DAY LILY	HEMEROCALLIS

EXISTING LANDSCAPING TO BE REPLACED WITH PAVERS = 575 SF  
 LANDSCAPING WITHIN THE MAIN FLOOR ADJACENT PROPERTY AS SCREEN.  
 RED LEAF BARBERY OR FORCETHYMA OR SAUSSUREA  
 EXISTING TREES TO BE REPLACED WITH 1 WISTERIA TREE  
 EXISTING LANDSCAPING TO BE REPLACED WITH SMALLER PLANTS  
 TO BE REPLACED WITH 100'S OF SMALLER PLANTS  
 SMALL BERM (6'-11")

**1 SITE PLAN, LANDSCAPE & PARKING**

1/8" = 1'-0"

ROBERTS ST.

SIDEWALK

ALLEY

PROPERTY LINE

PROPERTY LINE

PROPERTY LINE

PROPERTY LINE

PROPERTY LINE

EXISTING TRASH TO REMAIN  
10 SF

EXISTING TREES AND PLANTS TO REMAIN  
10 SF

EXISTING TREES AND PLANTS TO REMAIN  
60 SF

EXISTING TREES AND PLANTS TO REMAIN  
218 SF

ARTISTIC BIKE RACK  
INTEGRATED INTO BACK OF SIGN

POST ROLLED STEEL SIGN ON TWO STEEL  
COLUMNS 12" TALL COLUMNS 4" WIDE  
SIGN FROM 5' TO 6'

1 HANGING SPACES  
1 HANGING SPACES  
2 REQUIRED SPACES FOR EACH RESIDENTIAL UNIT ABOVE

ALL LOWER WINDOWS ALONG THE EAST SIDE ARE TO BE  
OPaque WINDOWS TO OBTAIN PRIVACY

ALL NEW SIDING ON BUILDING TO BE WOOD-LAP SIDING.